

# **Beta**

## **3050/MS**

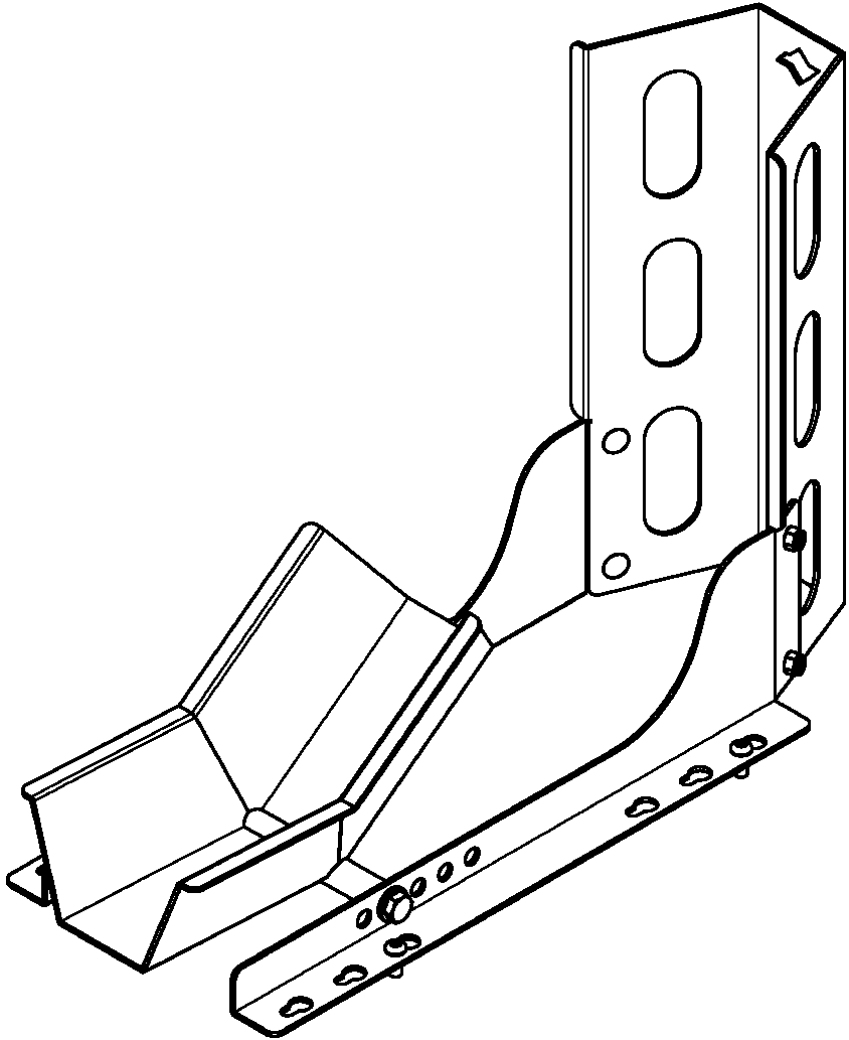

**I** ISTRUZIONI PER L'USO

**EN** INSTRUCTIONS FOR USE

# MORSA MECCANICA / MECHANICAL VISE

Montaggio supporti / Mounting of supports

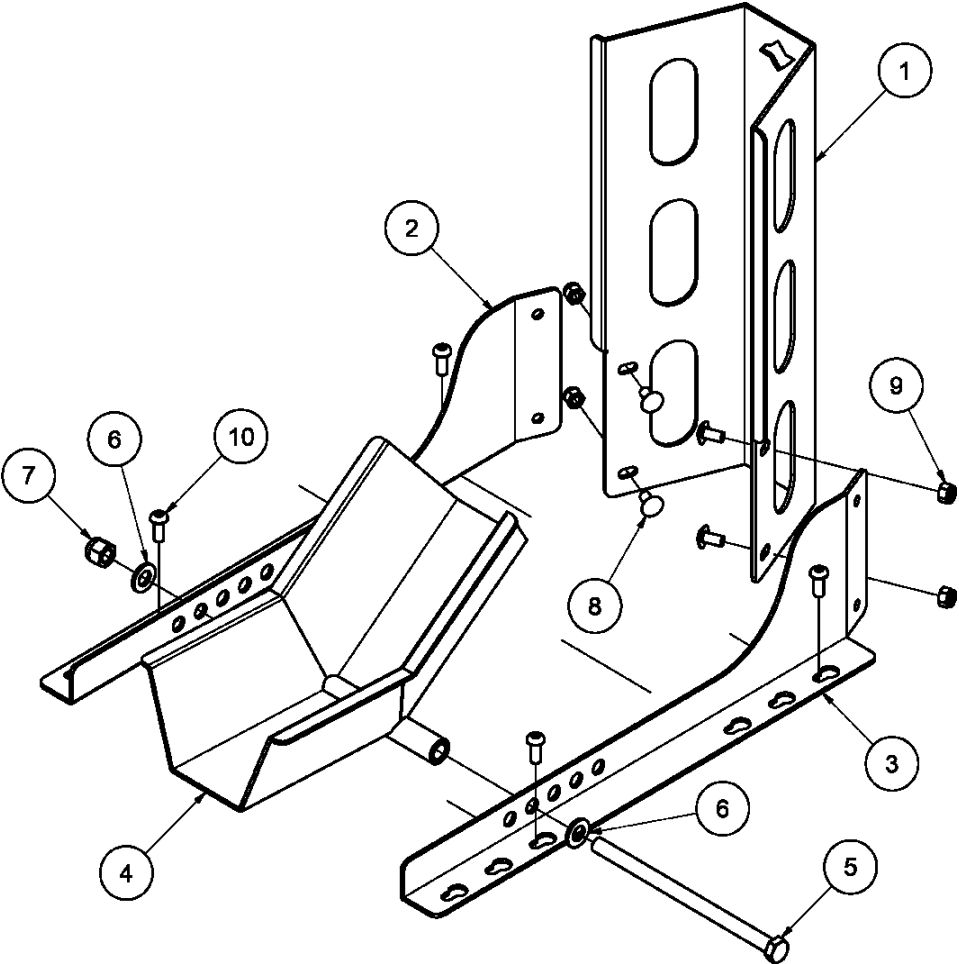

**ELENCO PARTI / PARTS LIST**

| ELEM. | QTY | DESCRIZIONE                                     | DESCRIPTION                            |
|-------|-----|---|--|
| 1     | 1   | Pannello frontale                               | Frontal panel                          |
| 2     | 1   | Fiancatina SX                                   | Left panel                             |
| 3     | 1   | Fiancatina DX                                   | Right panel                            |
| 4     | 1   | Sede ruota                                      | Wheel seat                             |
| 5     | 1   | Vite TE M 12x200                                | Hexagonal head screw M12x200           |
| 6     | 1   | Rondella piana ø 12 mm                          | Flat washer ø12 mm                     |
| 7     | 1   | Dado autobloccante M12                          | self-locking nut                       |
| 8     | 4   | Vite testa bombata M 8x16                       | Button head screw M8x16                |
| 9     | 4   | Dado con collare M8                             | Toothed nut M8                         |
| 10    | 2   | Vite a testa bombata ad esagono incassato M8x20 | Hexagon socket button head screw M8x20 |



**BETA UTENSILI S.p.A.**

via Alessandro Volta, 18 - 20845 Sovico (MB) ITALY

Tel. +39 039.2077.1 - Fax +39 039.2010742

[www.beta-tools.com](http://www.beta-tools.com)