

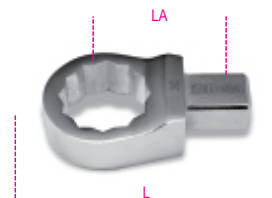



**Ring wrenches for torque bars, rectangular drive**

		art.	 mm	 mm	L mm	LA mm	A mm
	<b>006530008</b>	653 9X12-8	8	9x12	40	28,8	22
	<b>006530010</b>	653 9X12-10	10	9x12	43	28,8	22
	<b>006530012</b>	653 9X12-12	12	9x12	44	28,8	22
	<b>006530013</b>	653 9X12-13	13	9x12	44	28,8	22
	<b>006530014</b>	653 9X12-14	14	9x12	45	28,8	23
	<b>006530015</b>	653 9X12-15	15	9x12	46	28,8	25
	<b>006530016</b>	653 9X12-16	16	9x12	47	28,8	27,5
	<b>006530017</b>	653 9X12-17	17	9x12	47	28,8	27,5
	<b>006530018</b>	653 9X12-18	18	9x12	48	28,8	29
	<b>006530019</b>	653 9X12-19	19	9x12	49	28,8	31
	<b>006530022</b>	653 9X12-22	22	9x12	51	28,8	35
	<b>006530113</b>	653 14X18-13	13	14x18	61	39,8	32
	<b>006530114</b>	653 14X18-14	14	14x18	61	39,8	32
	<b>006530115</b>	653 14X18-15	15	14x18	62	39,8	32
	<b>006530116</b>	653 14X18-16	16	14x18	63	39,8	32
	<b>006530117</b>	653 14X18-17	17	14x18	64	39,8	32
	<b>006530118</b>	653 14X18-18	18	14x18	64	39,8	32
	<b>006530119</b>	653 14X18-19	19	14x18	66	39,8	32
	<b>006530121</b>	653 14X18-21	21	14x18	66	39,8	33
	<b>006530122</b>	653 14X18-22	22	14x18	67	39,8	35
	<b>006530124</b>	653 14X18-24	24	14x18	69	39,8	38
*	<b>006530127</b>	653 14X18-27	27	14x18	76	44,8	41,5
*	<b>006530130</b>	653 14X18-30	30	14x18	77	44,8	45
*	<b>006530132</b>	653 14X18-32	32	14x18	79	44,8	47,5
*	<b>006530134</b>	653 14X18-34	34	14x18	80	44,8	51
*	<b>006530136</b>	653 14X18-36	36	14x18	80	44,8	53
*	<b>006530141</b>	653 14X18-41	41	14x18	90	49,8	61